



Flat 6

Streatham Place | Streatham Hill | London | SW2 4PY

**£995 Per Month**

 **MovingInn**  
sales, lettings & management



# Flat 6

Streatham Place | Streatham Hill

London | SW2 4PY

£995 Per Month

Spacious studio flat to rent in the heart of Streatham Hill. Regulated Heating and Water Rates Included. Available now.

Moving Inn are proud to present this beautiful studio flat located on Streatham Place in Streatham Hill.

This bright and airy first floor studio flat has a kitchenette, shower and toilet and is offered with regulated gas central heating and water rates included in rent. Total floor area is 26.9 sq m.

The property location offers great transport links with the Streatham Hill train station located within 9 min walking distance, fantastic bus service, as well as easy access to restaurants, shops and amenities of Brixton Hill.

- Cosy studio in Streatham Hill
- Regulated Heating and Water Rates included
- Ideal for singles or couples
- Excellent transport links
- Viewing highly recommended
- Bright reception room
- Compact 26.9 sq m
- Close to local amenities
- Vibrant London location

Ground Floor  
289 sq.ft. (26.9 sq.m.) approx.

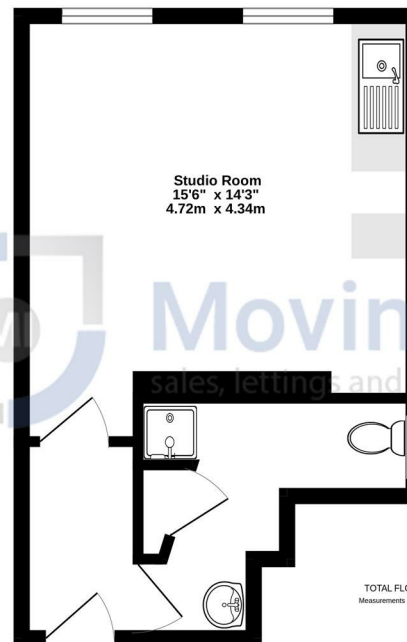

Streatham Place, London, SW2  
TOTAL FLOOR AREA: 289 sq.ft. (26.9 sq.m.) approx.  
Measurements are approximate. Not to scale. Illustrative purposes only  
Made with Metropix ©2025

Energy Efficiency Rating		
	Current	Potential
Very energy efficient - lower running costs		
(92 plus) A		
(81-91) B		
(69-80) C	73	78
(55-68) D		
(39-54) E		
(21-38) F		
(1-20) G		
Not energy efficient - higher running costs		
England & Wales		EU Directive 2002/91/EC

Council Tax Band A

EPC Rating C

467 Norwood Road

West Norwood

London

SE27 9DJ

02087610830

dean@movinginn.co.uk

www.movinginn.co.uk